



Year 4 – Materials and Complex Structures

Element 1 – Materials and Complex Structures

Mouldable Materials

What does mouldable mean? If something is mouldable, that means it can be something that can be made into different shapes. For example, clay, plasticine and salt dough are classed as mouldable materials.

When working with mouldable materials, the aim is to get your design/idea into the shape you would like and then it will harden. Some materials will simply harden by being left out in the 'air' whilst others need heat and have to be baked in order for them to harden.

Techniques

- Use your hands to roll the material into a ball shape.
- Roll the material into a 'snake' shape by rolling it back and forth on a flat surface.
- Use fingers/thumbs to squeeze the material.
- Use fingers/thumbs to pull and pinch the material.
- Carve details into the material using different tools.
- Smooth out the surfaces of the material by using your fingers to rub over it.
- Create holes or hollows in the material using different tools.
- Join pieces of different materials together e.g. Plasticene can be pinched/pressed together. Clay often uses water applied on the surface to make a 'glue' to help stick pieces together.

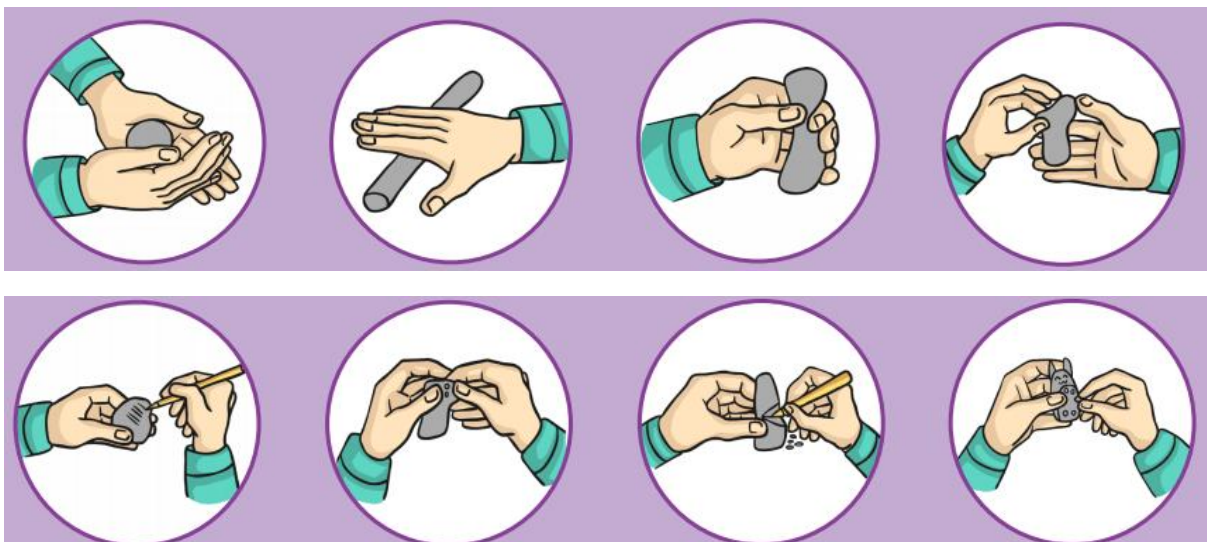



Famous Sculptors

- Michelangelo was a very famous artist who created sculptures, paintings and designed building as well.
- He was born on March 6th, 1475, in Caprese, Italy.
- He died on February 18th, 1564, in Rome, Italy.
- His most famous works are often said to be the sculpture 'David' and the paintings on the ceiling of the Sistine Chapel.

Follow the link below if you would like to learn more about him:

[Biography: Michelangelo Art for Kids \(ducksters.com\)](https://www.ducksters.com/art/biography_michelangelo.php)



Element 1 – Closed Test

- 1) What does it mean if a material is mouldable?
- 2) Can you name three different types of mouldable materials?
- 3) What technique is shown in the illustration below?



- 4) What was Michelangelo famous for?
- 5) When was Michelangelo born?



Element 2

Design Challenge – Use the link below to a recipe for making salt dough (Or you can use clay or plasticine if you have access to it). Once you have your material of choice, can you use it to make your own 'model' vehicle – this could be a car, plane, boat, train, whatever you would like it to be.

See if you can use at least 4 or 5 of the techniques from the information above during your creation. Remember to ask for adult supervision when working with any tools.

Good Luck! Send a photo into school of your vehicle is complete.

