



Wednesday 15 July 2020

Dear Parents & Carers

As you can imagine, planning for a safe return to school for all of our pupils is well underway and will be finalised during the last weeks of August, taking any amendments to Department for Education guidance into account. However, I would like to share with you our initial plans regarding the logistics of the school site and the school day, so that you are as much informed as possible at this time.

As we have had almost one third of the children back in school since June, we have been able to refine many of our routines for September and so the changes for the full return focus more on upscaling current plans to accommodate more children and staff.

The following provisional measures will be in place in September to support a safe return to school for the whole community:

1) Staggered start and end times of the day

To allow for necessary distancing to be maintained, we will need to operate different start and end times of the day. So far, due to the number of children on site, this has not been necessary. Once we open our doors to over 200 children, we will have to introduce this system to ensure safety. To allow for siblings to be dropped off together, we will group pupils by their surname for their allotted times:

Start of the School Day		End of the School Day	
Surnames A-G	8:30am	Surnames A-G	3:00pm
Surnames H-P	8:40am	Surnames H-P	3:10pm
Surnames Q-Z	8:50am	Surnames Q-Z	3:20pm

If you are joining Keyingham Primary for the first time in September, Miss Staniforth (our Home-School Liaison Officer) will be calling you to discuss your specific start times.

2) Site access for parents and carers

We will still have a heavily restricted visitors on site policy in place next term. If you wish to speak to your child's teacher or another member of staff, they will be able to speak to you on the phone or via a video call.

For drop off and pick up times, we will be operating a one-way system through the school playground and a fixed entry/exit point for pupils depending on their year group. I have attached a map of the school site to show you our plans but please be reassured that, in September, many members of staff will be on hand at these key times of the day to help everyone learn these new routines.

3) School lunch service

Our lunch menu will be back to full service in September and all meals can be ordered and paid for in advance via the School Gateway app. If you have yet to download the app, please do so as a matter of urgency. In order to reduce pupil circulation around the building, the classes will eat their lunch in their classroom before going out to play.

4) Wrap around care

From September, we will be working with a local provider to deliver a wrap around care service on our school site. Wrap around care in schools under current Department for Education guidance requires significant planning and safety systems of its own. We will send more information regarding this service out over the course of the summer holidays.

The staff are working hard to develop and adapt our school curriculum to support the children as the return to school full time. We are also reviewing our deployment of support staff to accommodate the needs of our pupils in a more appropriate way. Further changes in school include increased hygiene stations around the school and extra provision for blended learning for the next academic year, in case of further partial or full closures.

As ever, if you have any questions regarding the content of this letter, please do not hesitate to contact us at school either by email or phone. May I take this opportunity to wish you a happy, healthy and (hopefully) sunny summer. We look forward to seeing you all again in September!

Yours sincerely



Victoria White
Headteacher



KEYINGHAM PRIMARY

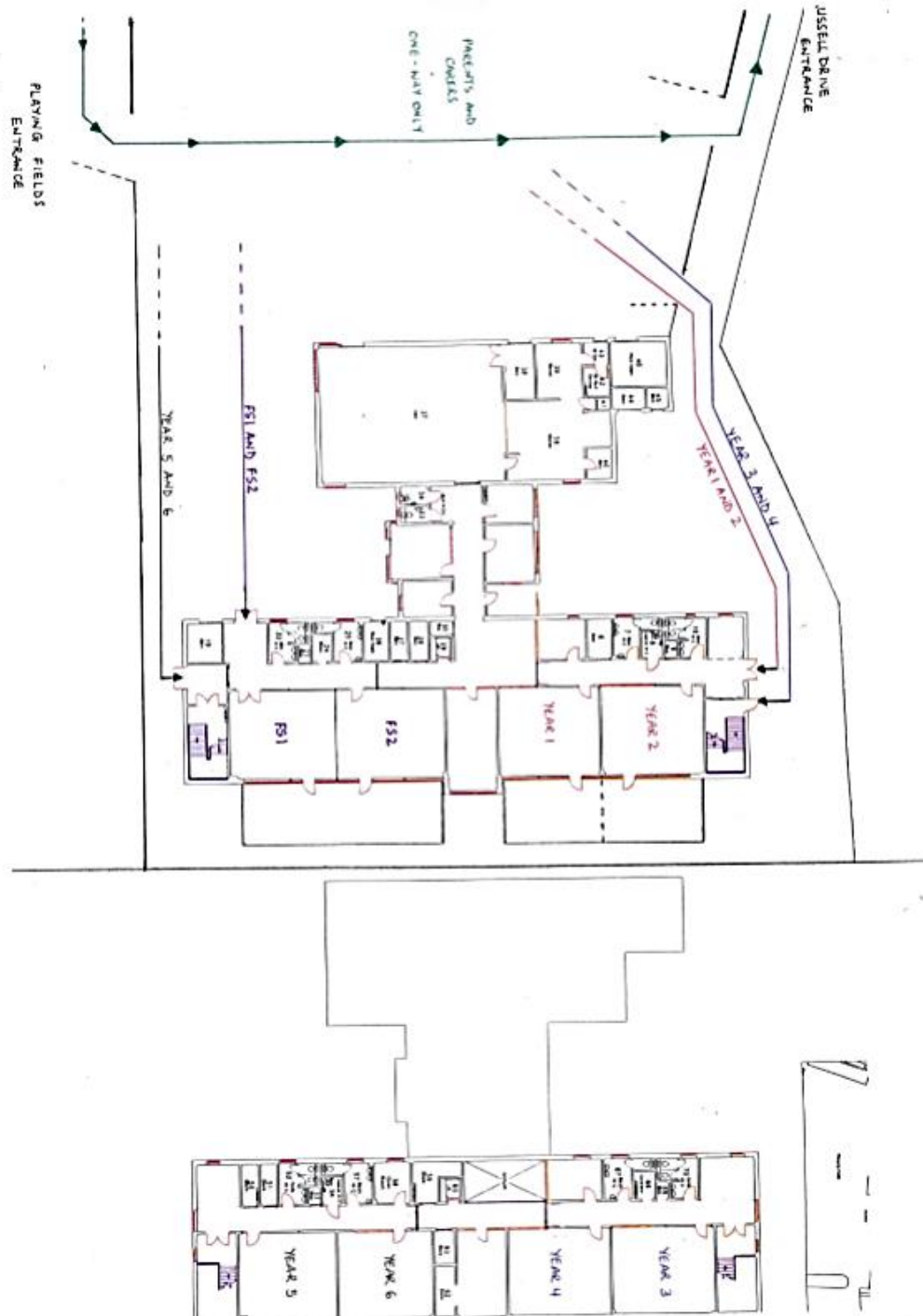

Keyingham Primary School
Russell Drive
Keyingham East Riding of Yorkshire
HU12 9RU

Tel: 01964 622319
Email: admin@keyinghamprimary.co.uk
www.keyinghamprimaryschool.co.uk

